

REVISIONS			
Rev.		Date	By
A	- Canopy amends	08/07/21	MJS

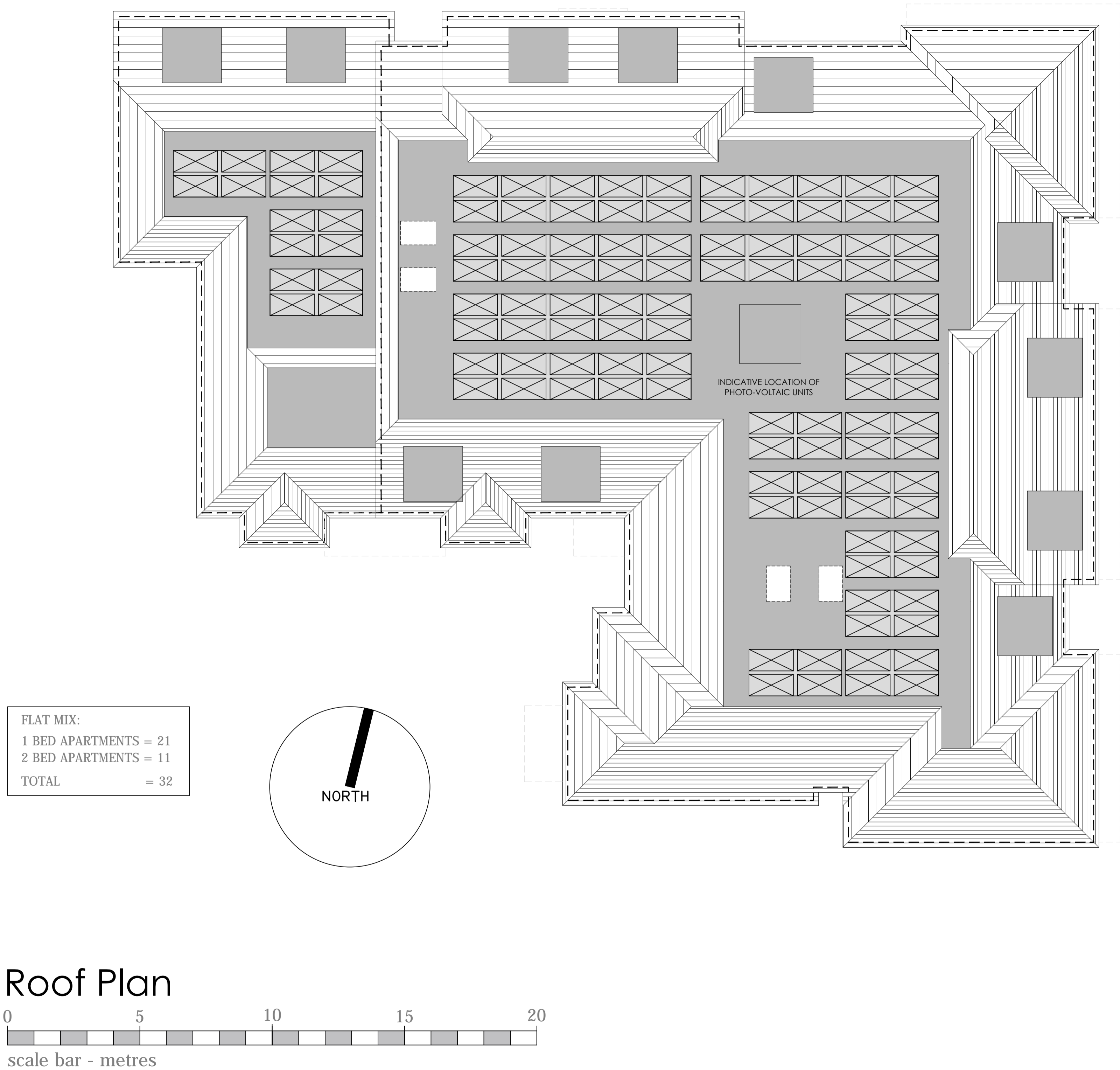

©CHURCHILL RETIREMENT LIVING

planning *issues*

TOWN PLANNING AND ARCHITECTURAL DESIGN

Rob Jackson RIBA

Design Director - South West

Churchill House \* Parkside

Ringwood \* Hampshire BH24 3SG

Telephone: (01423) 462372

Fax : (01423) 462101

Email: design@planningissues.co.uk

Client

**Churchill**

Retirement Living

Project Title

Retirement Living Apartments

Southampton Road

Lymington

Drawing Title

PROPOSED ROOF PLAN

Scale	1:100 @ A1	Date	14/06/21
Drawn	MJS	Checked	-
Drawing No.	10109LY-PA06 A		